

WS WALL SOCKET

User Guide

⚠ PLEASE READ BEFORE USE

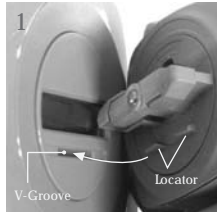

Align Locator on Eubiq Key* (FIG. 1) to V-Groove before inserting.

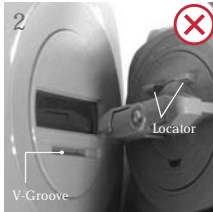

Do not insert Eubiq Key* (FIG. 1) without aligning Locator to V-Groove.



Turn accessory 90° clockwise ('Click' sound).



Accessory is now switched 'ON'. (LED indicator 'ON')



Keep away from fire.



Keep away from water.



Not for outdoor use.



To be installed by a qualified electrician/installer.

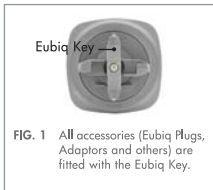

FIG. 1 All accessories (Eubiq Plugs, Adaptors and others) are fitted with the Eubiq Key.

3 Years Limited Warranty

1. Eubiq Pte Ltd ("Eubiq") warrants to the end-user of the ("the Customer") that the product will be free from defects in materials and workmanship under normal use for a period of three (3) years from the date of retail purchase by the original end-user purchaser ("Warranty Period").
2. The Customer should access and refer to Eubiq's website at www.eubiq.com for a list of Eubiq authorised dealers to contact for warranty service.
3. All requests for warranty service must be made within the Warranty Period, and be accompanied by the original dated proof of purchase.

Technical Specifications

Product Description	: Wall Socket
Rated Voltage	: 250 V a.c.
Rated Current	: 13 Amp
Frequency	: 50Hz
Terminal Capacity (Live, Neutral and Earth)	: 2 x 2.5mm ²
Ambient Operating Temp.	: -5°C to +40°C (Not to exceed an average of more than 35°C in any 24 hours period)
Degree of Protection	: Ordinary
Material (Enclosure)	: Polycarbonate
Metal Components Material	: Brass
Dimension	: 77mm x 77mm x 38mm
Weight	: Estimated 110 grams
Fixing Centre	: 60mm
Recommended Flush Boxes	: 'ABB', 'Jung' Moulded Type and Steel Type. Depth: Min. 5mm. Flush boxes shall comply to BS 4662

Wiring Instructions



To remove wall socket cover, insert test pen or screwdriver head into notch as shown above.

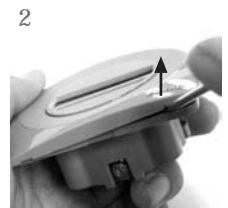

Tilt test pen or screwdriver upwards as shown, to disengage clip. Repeat for opposite notch.

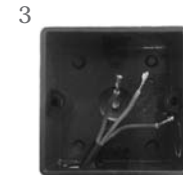

Bare the wires as shown.

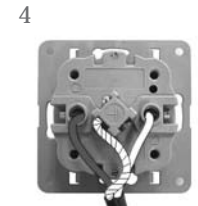

Terminate the wires to the respective terminals.

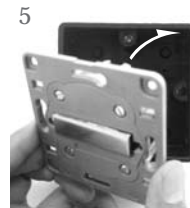

Mount the wall socket onto the wall box.

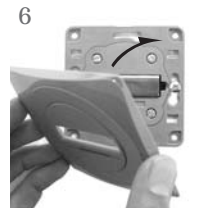

Attach the wall socket cover.



Wall socket is ready for use.

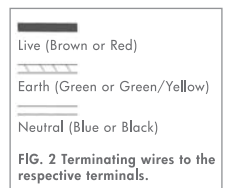

FIG. 2 Terminating wires to the respective terminals.