



PREMIUM SERIES

ADAPTOR / USB CHARGER

www.eubiq.com

USER GUIDE

TECHNICAL SPECIFICATION

		USB3 Premium USB Charger
Electrical	Input Voltage	AC100 - 250V ~
	Output Voltage	DC5.0V
	Rated Current	500mA max.
	Frequency	50Hz / 60Hz
Size and Weight	Diameter x Depth	67mm x 43mm
	Weight	Est. 100grams
Environmental	For indoor use only	
Function	USB Charger is designed to work with most devices that have USB charger connectors and do not require software or proprietary USB signalling for charging.	

Warranty 1 year subject to Eubiq Limited Warranty Statement



IMPORTANT SAFETY INFORMATION

- This user guide contains important product operating instructions, safety and maintenance information.
- Please read the user guide fully before use.



Do not slide adaptor along the track.



Keep away from fire.



Keep away from water.



Not for outdoor use.

CARE AND MAINTENANCE

The Premium Series Adaptor and USB Charger are products of superior design and craftsmanship and should be treated with care. The following information will help you to protect your warranty coverage.

- The product is specifically manufactured to be used and stored at room temperature. (-5°C to +40°C, not exceeding an average of more than 25°C in any 24 hours period)
- Keep the device dry.
- Do not store the product in dirty, dusty areas.
- Do not expose the product to rough handling.
- Do not use harsh chemicals, cleaning solvents or strong detergents to clean the product.

ADDITIONAL INSTRUCTIONS - PREMIUM USB CHARGER

- USB Charger is designed to work with most devices that have charger connectors and do not require software or proprietary USB signalling for charging.
- Parts of the device are magnetic. Metallic materials may be attracted to the device. Do not place credit cards or other magnetic storage media near the device, because information stored on them may be erased.
- Disengage the charger from the track when not in use. Do not leave a fully charged battery connected to a powered charger as overcharging may shorten its lifetime.
- USB Charger is designed to hold devices of maximum weight 135gm.
- * *USB connector cable is not included.*



Example shows the USB charger with a mobile phone attached.

Inner Surface

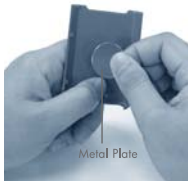

Metal Plate

Outer Surface

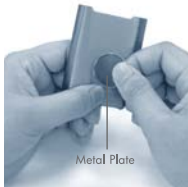

Metal Plate

3

To hold device against USB charger, remove adhesive on metal plate provided and fasten it to the inner or outer surface of device battery cover.

**PREMIUM
ADAPTOR**

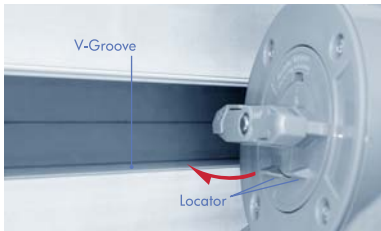

1 Align Locator to V-Groove.
Push adaptor to engage.



2 Charger is now in "ON" position.
(Blue LED indicator will illuminate)
To begin charging, insert USB connector
into the charger and insert charger plug
into charger connector on your mobile
device. **Reverse the steps to disengage.**



1 Align Locator to V-Groove.
Push charger to engage.
To **"ON"**, turn charger 90° clockwise
until a "click" sound is heard.



2 Turn adaptor approximately 45°
clockwise.
(Adaptor is now in **"OFF"** mode)



3 Insert plug into adaptor.

**PREMIUM
USB CHARGER**

TECHNICAL SPECIFICATION

			BS3*	FR3*	GS3*	JE3*	IN3*	IS3*
Electrical	Rated Voltage	250V a.c.	●	●	●	●	●	●
	Rated Current	6Amp					●	
		13Amp	●					
		16Amp		●	●	●	●	●
	Frequency	50Hz / 60Hz	●	●	●	●	●	●
Size and Weight	Diameter x Depth	67 x 38 mm					●	●
		67 x 43 mm	●					
		67 x 55.5 mm			●			
		67 x 58 mm		●		●		
	Weight (Estimated)	72grams	●					
		82grams		●	●	●	●	
		85grams						●
Environmental	Ambient Operating Temp.	-5°C to +40°C (not to exceed an average of more than 25°C in any 24 hours period)						
	Degree of Protection	Ordinary						

Warranty 3 years subject to Eubiq Limited Warranty Statement

* Premium Series Product Descriptions

BS3	Premium British Adaptor	IS3-RD16	Premium South African Dedicated Red Adaptor
FR3	Premium France Adaptor	IS3-BL16	Premium South African Dedicated Blue Adaptor
GS3	Premium German Adaptor	IS3-BK16	Premium South African Dedicated Black Adaptor
JE3	Premium Japan Adaptor		
IN3	Premium India Combo Adaptor		



To "ON", turn adaptor fully clockwise until a "click" sound is heard.

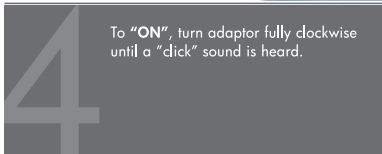



5
Adapter is now in **"ON"** position.
(Blue LED indicator will illuminate)



6
To **"OFF"**, turn adaptor anti-clockwise slightly until a "click" sound is heard. To **disengage** adaptor, turn anti-clockwise fully.